

TECHNICAL DATA (ENGINE)

Fig. 1: Engine Technical Data (1 Of 2)

MAZDA MOTORS CORP.

2005 Mazda RX-8 Shinka

Item				Specification				
				13B-MSP (Standard power)	13B-MSP (High power)			
MECHANICAL								
Drive belt deflection (with pressure of 98 N {10 kgf, 22 lbf})	(mm {in})	Generator	New	4.0—4.5 {0.16—0.17}				
			When adjusting	4.5—5.0 {0.18—0.19}				
			Deflection limit	6.0 {0.24} or more				
		A/C	New	3.0—3.8 {0.11—0.14}				
			When adjusting	3.3—4.0 {0.13—0.15}				
			Deflection limit	5.5 {0.21} or more				
Drive belt tension (when using the SST)	(N {kgf, lbf})	Generator	New	620—767 {63.3—78.2, 140—172}				
			When adjusting	519—666 {53.0—67.9, 117—149}				
			Deflection limit	344 {35.1, 77.3} or less				
		A/C	New	559—706 {57.1—71.9, 126—158}				
			When adjusting	519—617 {53.0—62.9, 117—138}				
			Tension limit	265 {27.1, 59.6} or less				
Compression pressure		Standard	830 {8.5, 120} [250 rpm]					
		Minimum	680 {6.9, 98.6} [250 rpm]					
		Standard difference in chambers	Within 150 {1.5, 21.8}					
		Standard difference in rotors	Within 100 {1.0, 14.5}					
Pushing distance of the rear oil seal				Until it is attached to the seating face of stationary gear				
Idle speed		(rpm)	AT	760—860				
			MT	750—850				
Idle-up speed*1	(rpm)	Electrical loads on*1	AT	N range	780—880			
				D range	760—860			
				R range	730—830			
			MT	Neutral	750—850			
				A/C on (standard)	AT	N range	780—880	
						D range	760—860	
		R range	730—830					
		MT	Neutral		760—860			
			A/C on (standard)+ electrical loads on*1		AT	N range	780—880	
						D range	760—860	
		R range		730—830				
		MT		Neutral	790—890			
				A/C on (heavy load)	AT	N range	800—900	
						D range	780—880	
		R range	780—880					
		MT	Neutral		790—890			

LUBRICATION SYSTEM					
Oil pressure (reference value) [oil temperature: 100°C {212°F}]		(kPa {kgf/cm ² , psi} [rpm])	350 {3.57, 50.8} [3,000]		
Oil capacity (approx. quantity)	Oil replacement		(L {US qt, Imp qt})	3.3 {3.5, 2.9}	
	Oil and oil filter replacement		(L {US qt, Imp qt})	3.5 {3.7, 3.1}	
	Engine overhaul		(L {US qt, Imp qt})	4.7 {5.0, 4.1}	
	Total (dry engine)		(L {US qt, Imp qt})	5.7 {6.0, 5.0}	6.4 {6.8, 5.6}
COOLING SYSTEM					

G03702101

Fig. 1: Identifying Ignition Coils, Spark Plugs, High-tension Lead
MAZDA MOTORS CORP.
 2005 Mazda RX-8 Shinka

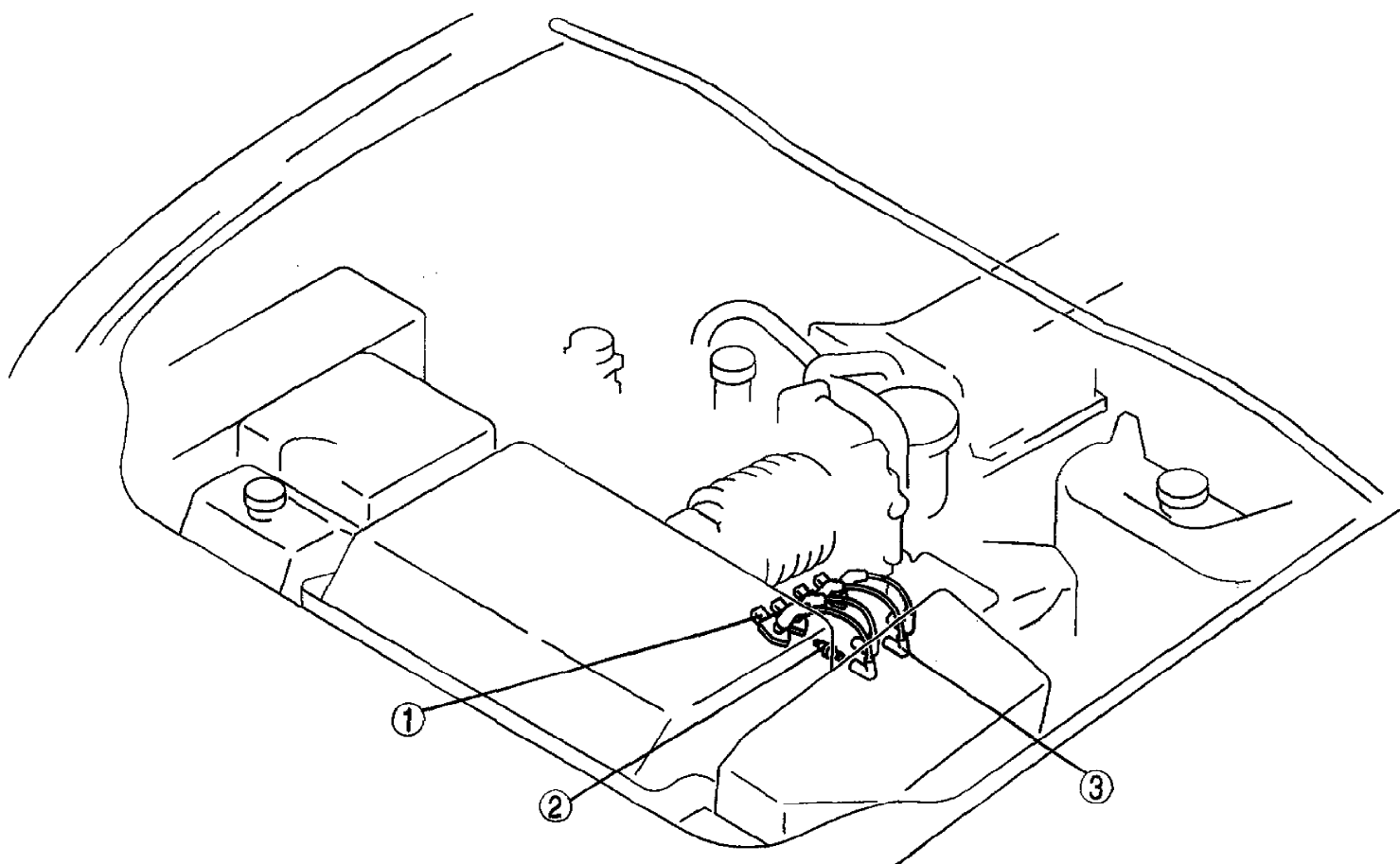

1	Ignition coil Bobina de encendido (See IGNITION COIL REMOVAL/ INSTALLATION.) (See IGNITION COIL INSPECTION.)
2	Spark plug (See SPARK PLUG REMOVAL/ INSTALLATION.) (See SPARK PLUG INSPECTION.)

3	High-tension lead (See HIGH-TENSION LEAD REMOVAL/ INSTALLATION.) (See HIGH-TENSION LEAD INSPECTION.)
---	--

G03702006

Fig. 3: Removing Ignition Coils With Torque Specification
MAZDA MOTORS CORP.
 2005 Mazda RX-8 Shinka

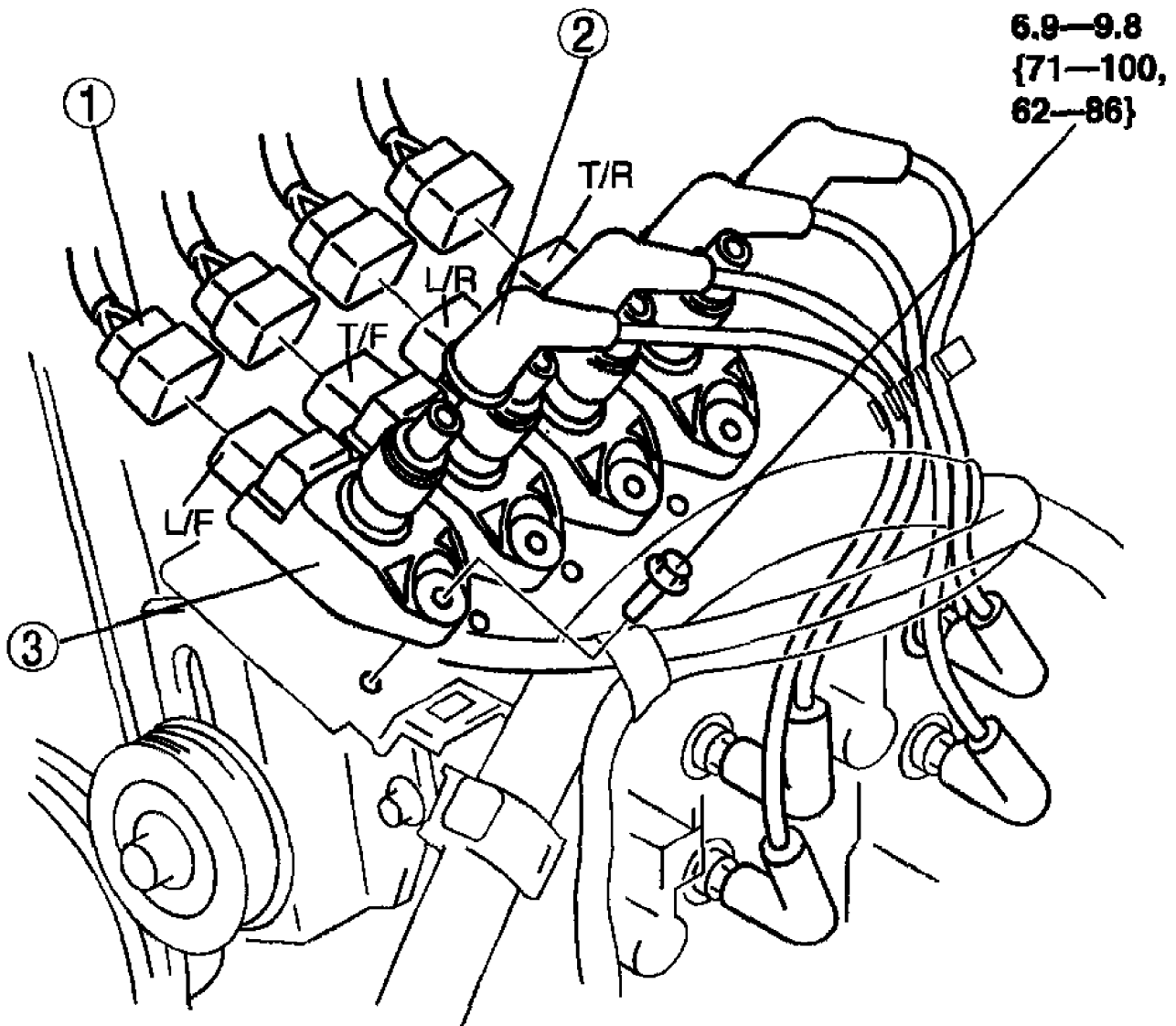

N·m {kgf·cm, in·lbf}

1	Connector
2	High-tension lead (See HIGH-TENSION LEAD REMOVAL/ INSTALLATION.)
3	Ignition coil

G03702007

Fig. 2: High Tension Wire Routing
MAZDA MOTORS CORP.
2005 Mazda RX-8 Shinka

